



ADVANCED HOT ARM

META Advanced Hot Arm



PRECISION ENGINEERING

PATENTED TECHNOLOGY provides superior flexibility and usability by clamping to most widths of cross arm including the round tubing of the common "chicken wing". The AHA can also utilize most steel eye loops for mounting with it's unique pin channel.



EFFICIENCY/ ERGONOMICS

Designed for rapid deployment and efficiency the AHA can be operated by any cordless drill with a 5/8" Hex drive and installed from either side without the need for tightening two clumsy screws. Equipped with durable rubber pads the clamping mechanism grips securely to fiberglass arms without damage.



DURABILITY

Made from **Machined Solid Billet** 6061 Aluminum and stainless steel, all components are superior in strength to common die-cast components and tested to stringent standards.



SAFETY

Fewer injuries, quicker installation, and cost savings by reducing exposure and limiting mundane, repetitive tasks. The AHA is the first hot arm capable of installation from one side in seconds.

WORKING LOAD LIMIT: 400 Lbs

TOTAL WEIGHT: 22 Lbs

DIMENSIONS: 72" X 2.5" Dia.

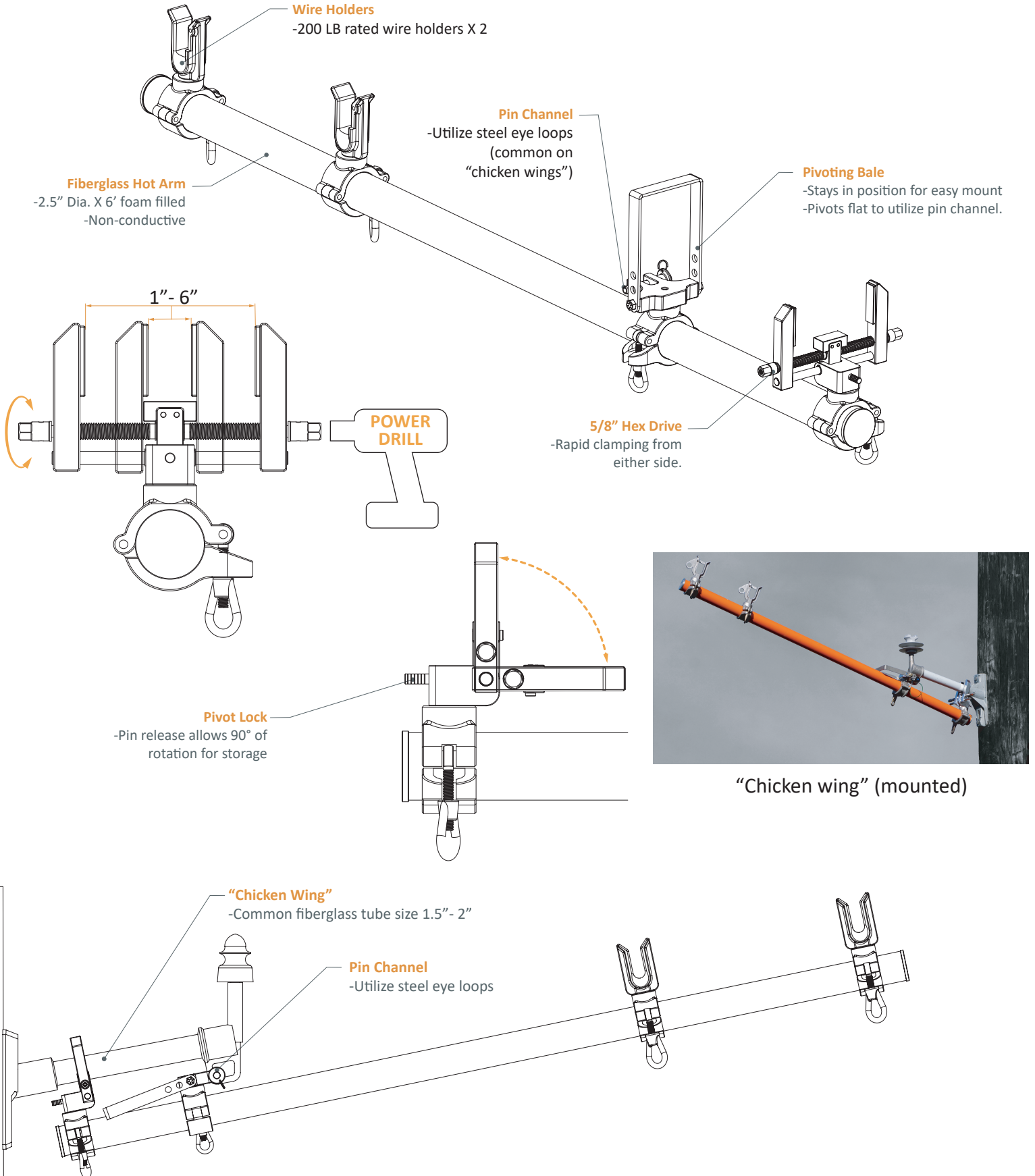

"Chicken wing" (mounted)

SHORT LEAD TIME - SHIPS ANYWHERE IN U.S.A. CALL 888 817-7018